

Plan

Notes

1. All the furniture parts shall be made of timber.
2. All parts of the furniture shall be 20mm thick timber except the back.
3. Proper joints with high quality glues shall be used in joineries.
4. All parts of the furniture shall be finished with water proof lacquer coating.
5. 6mm thick ply wood back for both table & drawer.
6. Drawer bottom to be made of 6mm thick ply wood.
7. Cabinet is inclusive of the work station.
8. All sharp edges to be rounded off.

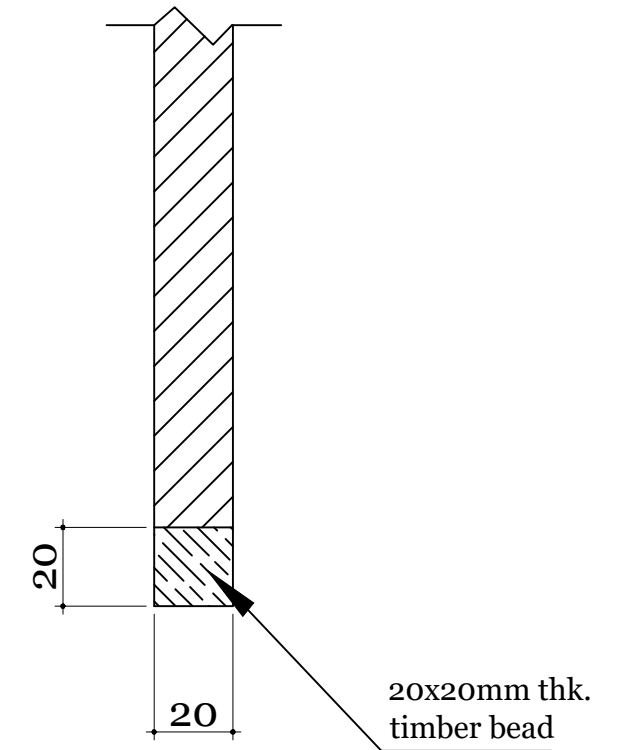

Detail A

Scale-1:2

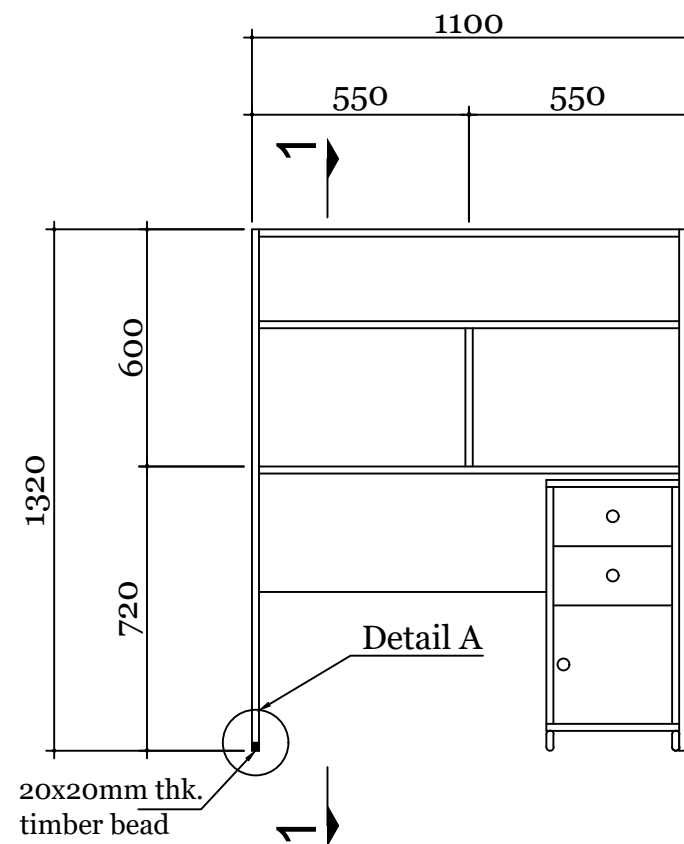

Front Elevation

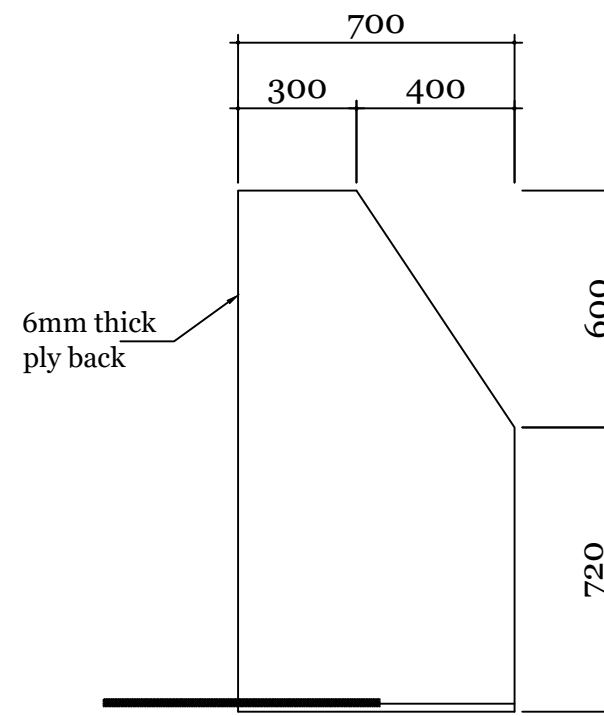

Side Elevation

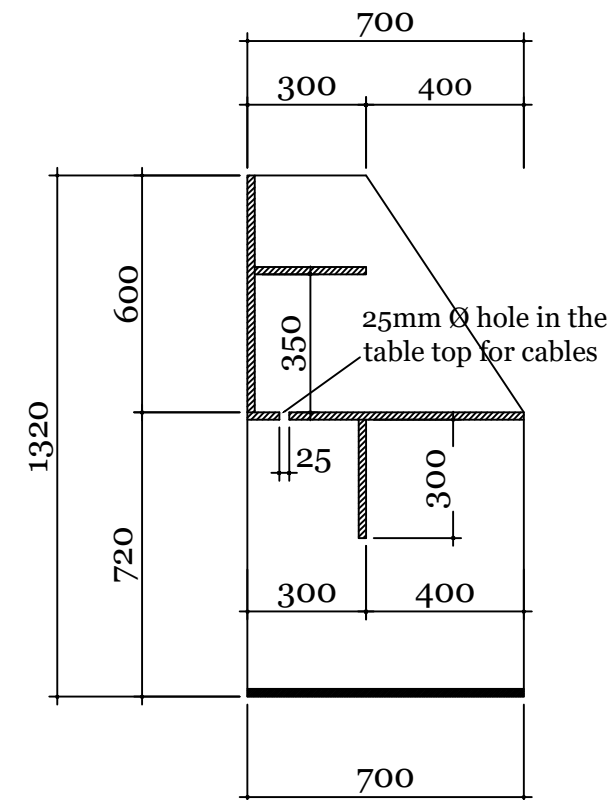

Section 1-1

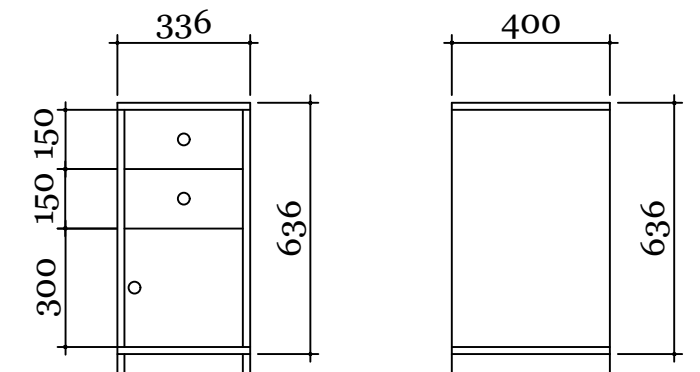

Cabinet Details

Notes:

Handles/knobs and locks to all drawers should be provided.



| 2019 | WORK STATION TABLE WITH CABINET | | |
|--------------------------|----------------------------------|----------------|-----------------|
| | TITLE: PLAN,ELEVATION & SECTIONS | | |
| HON'BLE SECRETARY MOE | CHIEF ENGINEER | ARCHITECT | ENGINEER |
| DIRECTOR, DOS | DRAWN BY | SCALE 1:20,1:2 | DATE 12/12/2011 |

NOTES:

- ALL DIMENSIONS ARE IN MM UNLESS SPECIFIED OTHERWISE.
- ALL DIMENSIONS MEASURE UNFINISHED SURFACES UNLESS SPECIFIED OTHERWISE.
- ALL DIMENSIONS ARE TO BE READ AND NOT SCALED OFF.
- ANY DISCREPANCIES IN DRAWINGS SHOULD IMMEDIATELY BE BROUGHT TO THE NOTICE OF THE SPBD DESIGN TEAM

| REVISION | DATE | DRAWING CODE: |
|--------------|------------|---------------|
| Mani Pradhan | Sept. 2019 | FURN-TA |
| | | DRAWING NO: |
| | | TA-11 |